

IR HDCVI Vari-focal Dome

2MP Dome Camera



HDCVI

- 2MP Max 30fps@1080p
- Long Distance Real-time Transmission
- Vari-focal Lens 2.7-12mm
- Smart IR 30m (98ft)
- Outdoor Rated IP67
- Vandal Rated IK10



System Overview

Experience full HD 1080p video with the simplicity of using existing coaxial infrastructure. The HDCVI Dome camera offers a discreet, compact design with integrated Smart IR illumination for distances up to 30m (98ft). Delivering full HD 1080p over a single coaxial cable provides the best of both worlds for users who want to maintain their existing analog infrastructure but want high definition images at a more affordable price. The sleek design makes the HDCVI Dome camera ideal for small to mid-size businesses where aesthetics are important.

Functions

3 Signals over 1 Coaxial Cable

Dahua's patented HDCVI technology bridges the gap between low resolution analog and high definition IP for users who require higher quality video without upgrading to IP. HDCVI technology supports 3 signals (audio, video and data) to be transmitted simultaneously over 1 coaxial cable. The camera offers 1080p/720p high resolution video and communicates with HCVR through control signals.

Long Distance Transmission

The HDCVI Dome camera combines high definition resolution with the simplicity of coaxial infrastructure for an easy upgrade. HDCVI technology guarantees long-distance and real-time transmission without any loss of signal. It supports 1200m and 800m signal transmission for 720p and 1080p respectively via RG6 coaxial cable, and 800m and 500m for 720p and 1080p respectively via RG59 coaxial cable. With a CAT6 UTP cable, the transmission distance reaches up to 450m and 300m for 720p and 1080p respectively*.

*Actual results verified by real-scene testing in Dahua's test laboratory.

Simplicity

HDCVI blends high quality images, affordability, and ease of use by utilizing traditional analog technology. Dahua HDCVI cameras are designed to make installation easy for a seamless upgrade from traditional analog without replacing existing coaxial cabling. The plug and play approach enables full HD video surveillance without the hassle of configuring a network.

Smart IR

With IR illumination, detailed images can be captured in low light or total darkness. The camera's Smart IR technology adjusts to the intensity of camera's infrared LEDs to compensate for the distance of an object. Smart IR technology prevents IR LEDs from whitening out images as they come closer to the camera. The camera's integrated infrared illumination provides high performance in extreme low-light environments up to 30m (98ft).

Protection

The camera's outstanding reliability is unsurpassed due to its rugged design. The camera is protected against water and dust to IP67 standards, making it suitable for indoor or outdoor environments. With its IK10 rated impact resistant design, the camera provides maximum durability against vandals making it capable of withstanding the equivalent of 55 kg (120lbs) of force.

Supporting $\pm 20\%$ input voltage tolerance, this camera suits even the most unstable conditions for outdoor applications. Its 4KV lightning rating provides protection against the camera and its structure from the effects of lightning.

Technical Specification

Camera

Image Sensor	1/2.7" CMOS
Effective Pixels	1920(H) × 1080(V), 2MP
Scanning System	Progressive
Electronic Shutter Speed	1/50(60)s~1/100,000s
Minimum Illumination	Color: 0.02 Lux@F1.4; B/W: 0 Lux@F1.4 (IR On)
S/N Ratio	More than 65dB
IR Distance	IR Distance Up to 30m (98ft)
IR On/Off Control	Auto
IR LEDs	2

Lens

Lens Type	Vari-focal Lens / Fixed Iris
Mount Type	Board-in
Focal Length	2.7mm - 12mm
Max Aperture	F1.4
Angle of View	H: 99° - 37°
Focus Control	Manual
Close Focus Distance	50mm ~ 270mm (1.97" ~ 10.63")

Pan / Tilt / Rotation

Pan/Tilt/Rotation	Pan: 0° ~ 355° Tilt: 0° ~ 75° Rotation: 0° ~ 355°
-------------------	---

Video

Resolution	1080p (1920×1080)
Frame Rate	30fps@1080p
Video Output	1-channel BNC HDCVI High Definition Video Output
Day/Night	Auto (ICR)
BLC Mode	BLC
White Balance	AWB
Gain Control	AGC
Noise Reduction	2D
Smart IR	Auto

Certifications

Certifications	FCC, UL
----------------	---------

Electrical

Power Supply	12V DC ±20%
Power Consumption	Max. 5.8W (12V DC, IR on)

Environmental

Operating Conditions	-30°C ~ +60°C (-22°F ~ +140°F) / Less than 90% RH * Start up should be done at above -30°C (-22°F)
Storage Conditions	-30°C ~ +60°C (-22°F ~ +140°F) / Less than 90% RH
Ingress Protection & Vandal Resistance	IP67 / IK10

Construction

Casing	Aluminium
Dimensions	Φ122.0mm × 88.9mm (Φ4.80" × 3.50")
Net Weight	0.45kg (0.99lb)
Gross Weight	0.58kg (1.28lb)

Ordering Information

Type	Part Number	Description
2MP Camera	DH-HAC-HDBW12A0RN-VF (2.7-12mm)	1080p, 2.7mm-12mm, True D/N, 30fps@1080p, IP67, IK10, Smart IR: up to 30m (98ft)
Accessories	PFA137	Junction box
	PFB203W	Wall mount bracket (for use alone or with PFA152 pole mount)
	PFA152	Pole mount bracket (for use with PFB203W wall mount)
	PFB200C	In-ceiling mount bracket
	PFA150	Pole mount bracket (for use with PFA137)
	PFA151	Corner mount bracket (for use with PFA137)

Dimensions (mm/inch)

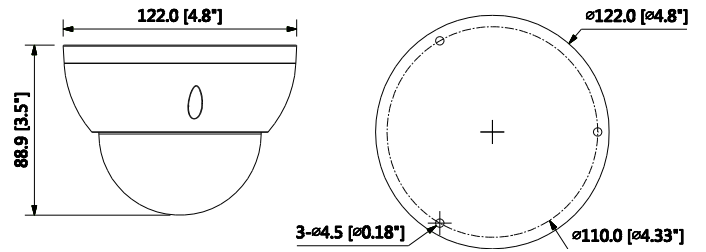

Accessories

Optional:



PFA137
Junction Box



PFB203W
Wall Mount



PFA152
Pole Mount

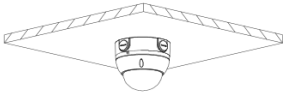
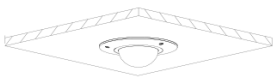

PFB200C
In-ceiling Mount

Junction Mount	Inceiling Mount
PFA137	PFB200C
	
Wall Mount	Pole Mount
PFB203W	PFB203W + PFA152
