

HDCVI Mini PTZ Dome

2MP 4x HDCVI Camera



HDCVI

- Max 60fps@720p and 30fps@1080p
- Powerful 4x Optical Zoom
- DWDR
- HD and SD Switchable
- Outdoor Rated IP66
- Vandal Resistant IK10



System Overview

The 2-megapixel resolution, Pan/Tilt/Zoom (PTZ) camera with a 4x optical zoom lens adopts a high performance sensor, providing clear images with abundant details and exceptional color rendition. The camera features a HD/SD dual-output and a multi-language OSD.

Functions

Multi-language OSD

The OSD menu provides various configurations for common monitoring requirements. The camera supports 10-language OSD including: Chinese, English, French, German, Spanish, Japanese, Korean, Russian and Polish. For adapting different daytime/lowlight scenes or image style preferences, image parameters and IR options can be applied. In applications pointing to intense light, the WDR feature can be enabled. In addition, advanced features such as Privacy Mask, Motion Detect and Defog are available for specific application.

Protection

The camera's outstanding reliability is unsurpassed due to its rugged design. With its IK10 rated impact resistant design, the camera provides maximum durability against vandals making it capable of withstanding the equivalent of 55 kg (120lbs) of force.

Simplicity

HDCVI blends high quality images, affordability, and ease of use by utilizing traditional analog technology. Dahua HDCVI cameras are designed to make installation easy for a seamless upgrade from traditional analog without replacing existing coaxial cabling. The plug and play approach enables full HD video surveillance without the hassle of configuring a network.

3 Signals over 1 Coaxial Cable

Dahua's patented HDCVI technology bridges the gap between low resolution analog and high definition IP for users who require higher quality video without upgrading to IP. HDCVI technology supports 3 signals (audio, video and data) to be transmitted simultaneously over 1 coaxial cable. The camera offers 1080p/720p high resolution video and communicates with HCVR through control signals.

Environmental

With a temperature range of -30°C ~ +60°C (-22°F ~ +140°F), the camera is designed for extreme temperature environments. Subjected and certified to rigorous dust and water immersion tests, the IP66 rating makes it suitable for demanding outdoor applications.

Protection

Supporting $\pm 25\%$ input voltage tolerance, this camera suits even the most unstable conditions for outdoor applications. Its 8KV lightning rating provides protection against the camera and its structure from the effects of lightning.

Technical Specification

Camera

Image Sensor	1/2.7" CMOS
Effective Pixels	1920 H x 1080 V
Scanning System	Progressive
Electronic Shutter Speed	1/1 ~ 1/30,000s
Minimum Illumination	Color: 0.05Lux@F1.6; B/W: 0.005Lux@F1.6; 0Lux (IR on)
S/N Ratio	More than 55dB
IR LEDs	N/A

Lens

Lens Type	Motorized/ Auto Iris
Mount Type	Board-in
Focal Length	2.7mm~11mm (4x Optical zoom)
Max Aperture	F1.6 ~ F3.0
Angle of View	H: 112.5°~39°
Focus Control	Auto / Manual
Close Focus Distance	100mm~ 1000mm

PTZ

Pan/Tilt Range	Pan: 0° ~ 355° endless; Tilt: 0° ~ 90°, auto flip 180°
Manual Control Speed	Pan: 0.1° ~100° /s; Tilt: 0.1° ~60° /s
Preset Speed	Pan: 100° /s; Tilt: 60° /s
Presets	300
PTZ Mode	8 Tour, Auto Scan
Speed Setup	Human-oriented focal length/ speed adaptation
Power up Action	Auto restore to previous PTZ and lens status after power failure
Idle Motion	Activate Preset/ Scan/ Tour/ Pattern if there is no command in the specified period
Time Task	Auto activation of Preset/ Pan/ Scan/ Tour/ Pattern by preset-time
Protocol	DH-SD, Pelco-P/D (Auto recognition)

Video

Resolution	30fps@1080p, 30/60fps@720p
Video Output	1-channel BNC HDCVI high definition video output/ CVBS standard definition video output
Day/Night	Auto (ICR) / Color / B/W
BLC Mode	BLC / HLC / DWDR
White Balance	Auto, ATW, Indoor, Outdoor, Manual
Gain Control	Auto / Manual
Noise Reduction	Ultra DNR (2D/3D)
Digital Zoom	16x
Flip	0°/180°
Privacy Masking	Up to 24 areas

Certifications

Certifications	FCC (SEFD1505003-A) UL (E234884-A67-UL)
----------------	--

Interface

Audio Interface	N/A
RS485	1
Alarm	N/A

Electrical

Power Supply	DC12V
Power Consumption	Max. 10W

Environmental

Operating Conditions	-30°C ~ +60°C (-22°F ~ +140°F) / Less than 90% RH *Start up should be done at above -35°C (-31°F)
Storage Conditions	-30°C ~ +60°C (-22°F ~ +140°F) / Less than 90% RH
Ingress Protection & Vandal Resistance	IP66, IK10

Construction

Casing	Metal
Dimensions	Φ122mm x 89mm (Φ4.80" x 3.50")
Net Weight	1.42 kg (3.13 lbs)
Gross Weight	0.6kg (1.32lbs)

Ordering Information

Type	Part Number	Description
2MP Camera	DH-SD22A204IN-GC	2MP HD PTZ 4x Optical Zoom, True D/N, DWDR
Accessories	Power Supply	DC12V (included)
	PFB202W	Wall Mount Bracket
	PFB200C	Ceiling Mount Bracket
	PFA137	Water-proof Junction Box
	PFA152	Pole Mount Bracket

Dimensions (mm/inch)

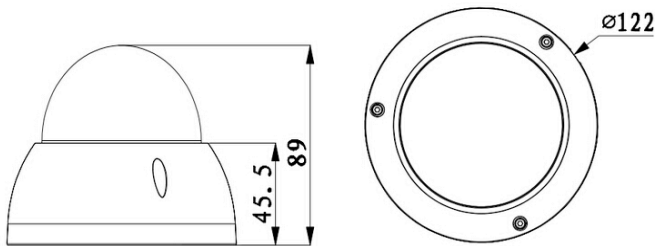

Accessories

Optional:

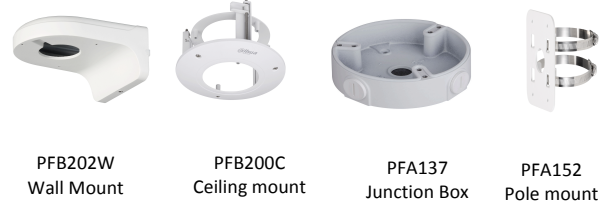

Wall Mount	Ceiling Mount
PFB202W	PFB200C
Junction Mount	Pole Mount
PFA137	PFB202W+PFA152