

PFM700

HDMI Extender



Features

- Power supply: Input voltage DC5V.
- Transmission effect: Real-time transmission HDMI video signal, no delay, strong anti-interference.
- Transmission distance: HDMI transmission distance 60M (max)
- Main functions: Use single UTP (CAT-5E and CAT-6) transmit 1-ch HDMI video signal: support HDMI 1.3.
- Protection and anti-interference: Excellent anti-thunder, anti-static and anti-interference capabilities.
- Appearance structure: No need to install driver program and set network parameters, easy to use and convenient to install.

PFM700

Specifications

Model	PFM700
Properties	
Transmission Signal	1channel HDMI
Transmission Distance	60M(max)
Video Transmission Properties	
Video Signal Input Interface	HDMI interface
Video Input Interface	HDMI interface
Twisted-pair Video Transmission Port	RJ45 port
Input Voltage	DC5V
Power	TX<3W, RX<3W
HDCP Version	Support HDCP1.2
HDMI Version	Support 1.3 and lower version
Resolution Output Signal	
Resolution	1080P/1080I/720P/576P/576I/480P/480I
Output Voltage	0.5~1.5Vp-p
Protection	
ESD	1a contact discharge electricity level 3
	1b air discharge electricity level 3
	Per: IEC61000-4-2 1995(GB/T 17626.5)
Anti-thunder	1KV
	Per: IEC61000-4-5 1995(GB/T 17626.5)
Stability	
MTBF	>5000H
Physical Properties	
Dimension(L*W*H)	Transmitter: 88mm×64mm×25mm(port length included) Receiver: 88mm×64mm×25mm
Shell	Aluminum
Color	Black
N.W.	Transmitter: 97g Receiver: 91g
Environmental	
Working Temperature	0-55℃
Storage Temperature	-20~80℃
Humidity	0~95%(non-condensing)
Certification	
Certification	CE, FCC

PFM700

Dimensions (mm)

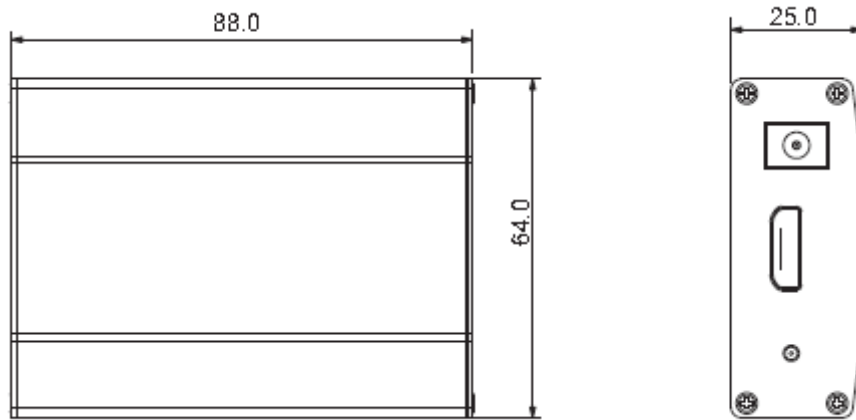

Application

